



STANDENS



AXLES

**Trailer Axles
and Components
3,500 LB.**



Top Quality Trailer Axles & Components

Standen's Warranty

IMT Standen's Limited Partnership warrants Axle products manufactured or supplied by us to be free from defects in material and workmanship under normal use and service for a period of one year from date of manufacture of the product.

We will repair or replace without charge, shipping included, or at our option give credit for components shown to be out of specifications or defective.

This replacement warranty is limited to parts only and does not include any labour charges, down time costs or consequential costs due to the defective product.

The warranty on our product is void when:

1. Axle capacity is exceeded.
2. The brakes are not adjusted before the trailer is put into use.
3. Products are not installed according to factory recommendations and maintained.
4. Proper maintenance is not carried out.
5. Our products are altered or changed from original factory specifications without our knowledge and consent.
6. Damage occurs due to destructive driving or road conditions.
7. The product sits idle longer than 3 months and is not pre-serviced before being put into service.

This limited Warranty applies to the first use purchaser of the product only.

This limited Warranty is the only Warranty offered by us and therefore no employees, agent, salesperson or other person has the authority to offer or make any other Warranty.

Axle Division Return Policy

AXLES CAN NOT BE RETURNED SPECIAL ORDER PARTS CAN NOT BE RETURNED

RETURNS ARE NOT ACCEPTED AFTER 30 DAYS OF PURCHASE DATE

There is no restocking fee associated with parts returned within 10 DAYS OF PURCHASE however parts returned after 10 days are subject to a 20% restocking fee.

A COPY OF THE ORIGINAL INVOICE MUST
ACCOMPANY ALL RETURNS

ALL RETURNS MUST BE PREVIOUSLY APPROVED
WITH AN RGA NO.

PARTS MUST BE RETURNED FREIGHT PREPAID

How to Measure an Axle

There are many ways to measure the length of an axle beam. The most accurate way to measure would be → **hub-face-to-hub-face** and **spring-center-to-spring-center** lengths.

What is the hub face measurement? Hub face is the distance from outside of hub mounting face to outside of hub mounting face. The hub face is also known as the mounting surface where the wheel makes contact with the hub. (See straight axle reference diagram below)

The **spring centers** identify the position of the springs and mounting hardware, as well this should align with the mounting positions on the trailer frame rails.

Please note that the springs can be mounted above (overslung) or below (underslung) the axle. This will raise or lower the axle depending on the configuration.

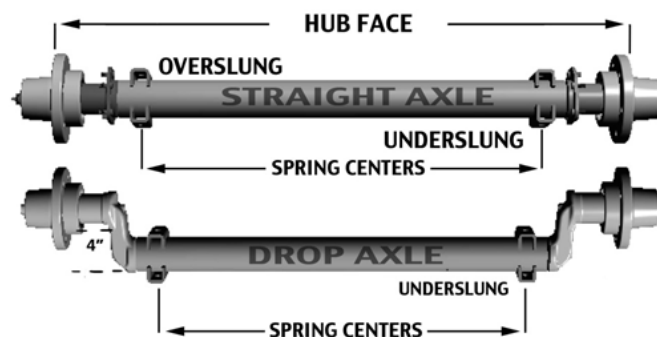

Alternatively - the flange face to flange face measurement can be provided which is measured from the outside of one brake flange to the outside of the opposite one (Where the brakes bolt on) as you see below.

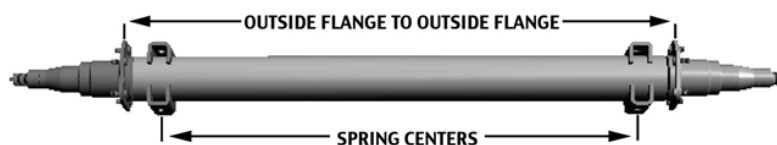

This length may be easy to obtain if you are replacing an axle, but it's important to note that this measurement is not the preferred method for determining which axle will best fit your trailer.

Hub face & spring center measurements are required before any order will be built.

3,500 LB CAPACITY S-35 H HUB GROUP WITH OPTIONAL BOLT CIRCLE

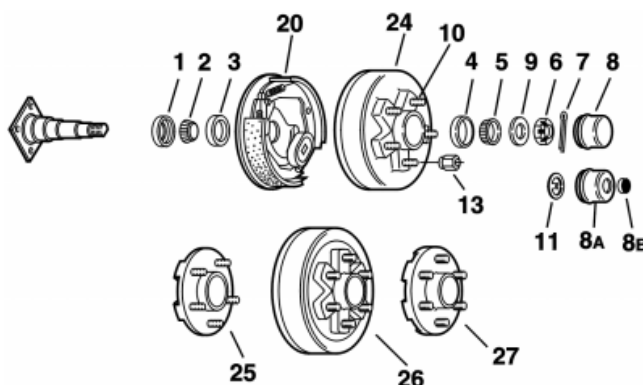

STANDARD GREASE LUBE PARTS

Item	Part #	Description
	603	Bearing Kit - 1 Hub
1	SE-22EZ	Grease Seal
2	L68149	Inner Bearing Cone
3	L68111	Inner Bearing Cup
4	L44610	Outer Bearing Cup
5	L44649	Outer Bearing Cone
6	821-3	Spindle Nut
7	880-1	Cotter Pin
8	DC-11	Grease Cap
8A	DC-11A	Grease Cap for E-Z Lube
8B	85-1	Rubber Plug for E-Z Lube
9	841-1	Spindle Washer
11	841-5	Tang Washer for E-Z Lube

STUDS & WHEEL NUTS

Item	Part #	Description
10	WS-112	Wheel Stud
13	WN-2	1/2-20 Wheel Nut
10	WS-109	Wheel Stud 1/2x 1- 13/16



Hubs and Drums

Item	Part #	Description	Bolt Circle
* 24	9-545	10 x 2 1/4 Studded, 1/2-20	5 on 4.50
24	9-5475	10 x 2 1/4 Studded, 1/2-20	5 on 4.75
24	9-550	10 x 2 1/4 Studded, 1/2-20	5 on 5.00
24	9-555	10 x 2 1/4 Studded, 1/2-20	5 on 5.50
26	9-655	10 x 2 1/4 Studded, 1/2-20	6 on 5.50

10 X 2 1/4 BRAKES

Item	Part #	Description
* 20	12-1013	LH Electric
* 20	12-1014	RH Electric
* ns	13-1015	LH Hydraulic Uni-servo
* ns	13-1016	RH Hydraulic Uni-servo

Plain Hubs

Item	Part #	Description	Bolt Circle
25	8-545	Idler Hub Studded	5 on 4.50
25	8-5475	Idler Hub Studded	5 on 4.75
25	8-550	Idler Hub Studded	5 on 5.00
25	8-555	Idler Hub Studded	5 on 5.50
27	8-655	Idler Hub Studded	6 on 5.50

* North American and in house brand available

3,500 LB CAPACITY S-35 H HUB GROUP WITH OPTIONAL BOLT CIRCLE

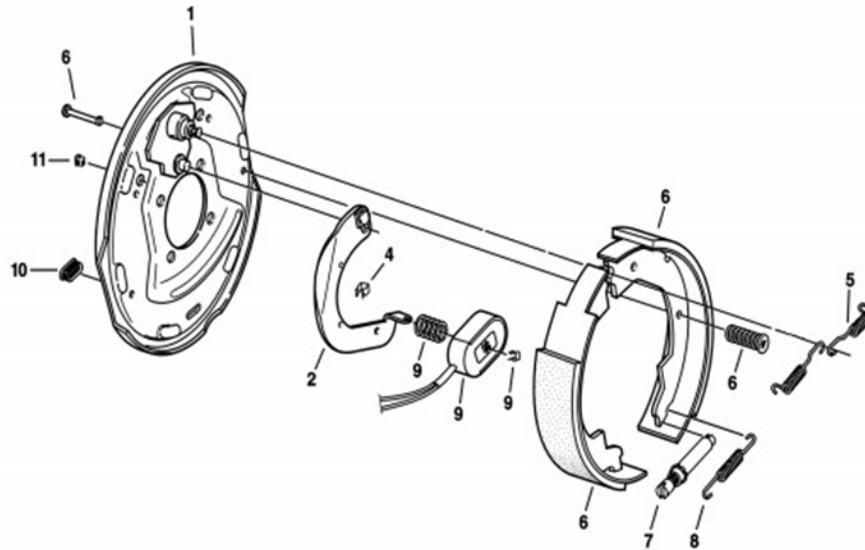

* Dexter model shown

ELECTRIC BRAKES & COMPONENTS

Item	Part #	Qty/Brk	Description
	* 12-1013	1	LH Complete Brake Assembly
	* 12-1014	1	RH Complete Brake Assembly
1	36-19-1	1	Backing Plate Assembly
2	47-19	1	LH Actuating Lever Arm
2	47-20	1	RH Actuating Lever Arm
4	27-5	3	Wire Clip
5	71-363	2	Spring Kit
6	71-47	1	Shoe & Lining Kit containing:
		1	#040-017-00 Primary S&L
		1	#040-021-00 Secondary S&L
		2	#049-002-00 Shoe Hold Down Pin #8
		2	#046-077-00 Shoe Hold Down Spring
7 & 8	71-324	1	43-4 - Adjuster Assembly
		1	46-18 - Adjusting Screw Spring
9	71-104	1	Magnet Kit containing:
		1	#042-097-01 Magnet (green wire)
		1	#027-009-00 Magnet Clip
		1	#046-080-00 Magnet Spring
10	46-7	1	Plug
11	46-46	1	Wire Grommet

10x 2 1/4" HYDRAULIC BRAKES

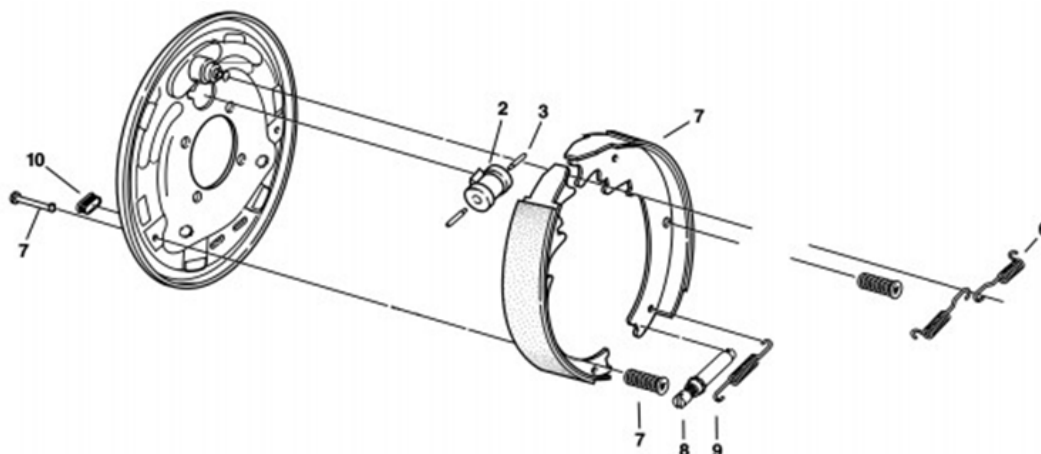

* Dexter model shown

HYDRAULIC BRAKES & COMPONENTS

Item	Part #	Qty/Brk	Description
	* 13-1015	1	LH Brake Assembly Complete-Uni-Servo
	* 13-1016	1	RH Brake Assembly Complete-Uni-Servo
2	71-337	1	LH Brake Cylinder Uni-Servo
2	71-338	1	RH Brake Cylinder Uni-Servo
3	54-60	1 or 2	Push Rod (1 for Uni, 2 for Duo)
6	71-363	1	Spring Kit
7	71-267	1	Shoe & Lining Kit containing:
		1	#040-210-00 Primary Shoe & Lining
		1	#040-211-00 Secondary Shoe & Lining
		2	#046-077-00 Shoe Hold Down Spring
		2	#049-002-00 Shoe Hold Down Pin #8
8 & 9	71-324	1	43-4 Adjuster Assembly
		1	46-18 Adjusting Screw Spring
10	46-7	1	Plug

LEAF SPRING APPLICATION INFORMATION DOUBLE EYE SPRING SUSPENSION

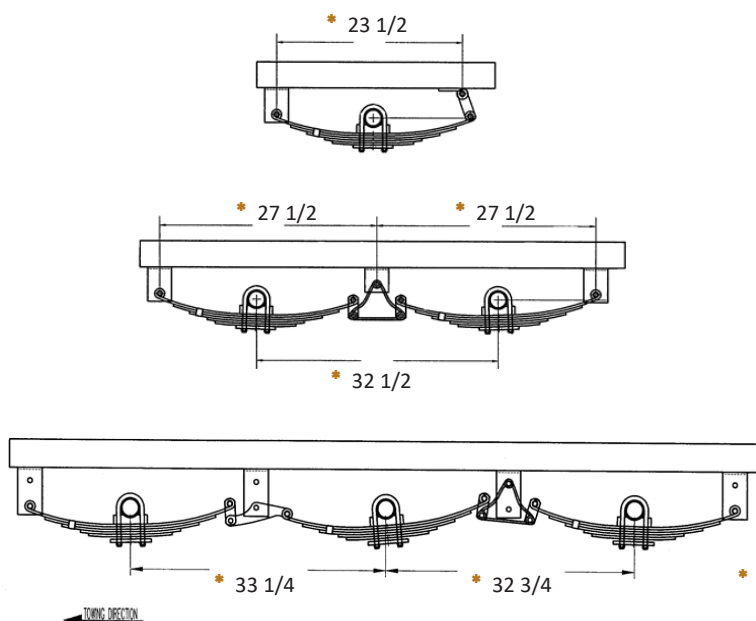

* Measurements will be Dependant on spring used

DOUBLE EYE SPRINGS

Spring

Part #	Capacity/Spring
125-3	1050 lbs.
125-4	1350 lbs.
125-5	1750 lbs.

Triple Hanger Kit Part #578-0

Part #	Capacity/Spring
540-14	Equalizer Hangers
540-7	Front & Rear Hangers
542-1	Equalizer - Front
543-0	Equalizer - Rear
545-2	Shackle Strap
801-1	9/16 Shackle Bolt
810-2	7/16 Flanged Lock Nut

Single Hanger Kits Part #576-0

Part #	Capacity/Spring
540-2	Front Hanger
540-10	Rear Hanger Eye
545-3	Shackle Strap 3 inch
801-1	9/16 Shackle Bolt
810-2	7/16 Flanged Lock Nut

Tandem Hanger Kit Part #577-0

Part #	Capacity/Spring
540-2	Front and Rear Hanger
540-14	Centre Hanger
543-0	Equalizer
545-225	Shackle Strap
801-1	9/16 Shackle Bolt
810-2	7/16 Flanged Lock Nut



Some combinations of hangers and spring mounting may result in insufficient bump clearance.

LEAF SPRING APPLICATION INFORMATION

SLIPPER SPRING SUSPENSION

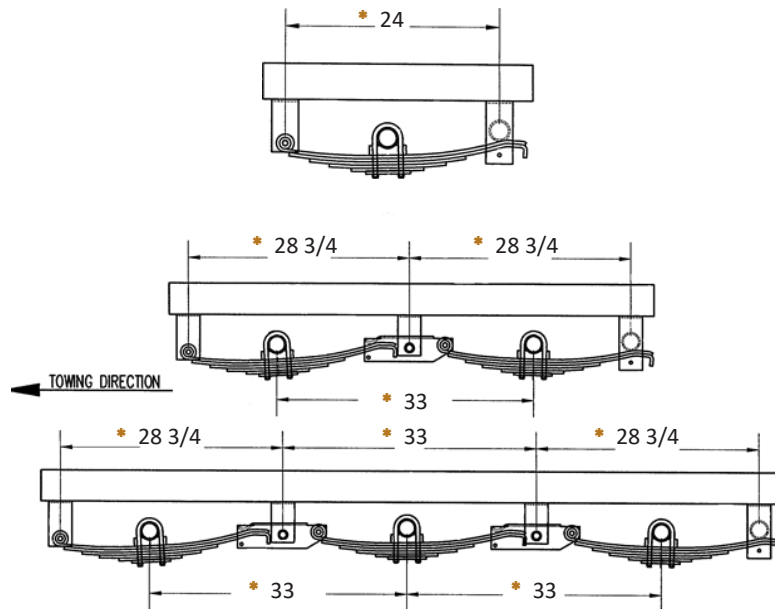

* Measurements will be
Dependant on spring used

Some combinations of hangers and spring mounting may result in insufficient bump clearance.

SLIPPER SPRINGS

Spring

Part #	Capacity/Spring
80-3T3	2000 lbs
120-3T3	3500 lbs
140-3T3	4000 lbs

Triple Hanger Kit

Part # 572-33-HD

Part #	Description
28-001-58HD	Front Hanger
29-001HD	Center Hanger 3.5" High Heavy Duty
30-028HD	Rear Hanger
541-3-58	Equalizer 5/8"
6-111	7/8" NC Lock Nut for 7-1-1
7-1-1	7/8" NC Equalizer Bolt w/Zirk
800-1	3/8 X 3-1/2" NF Bolt
801-2	5/8" NF Suspension Bolt
820-1	3/8" NF Nylock, Plated
820-5	5/8" NF Lock Nut Plated

Single Hanger Kit

Part# 570-0-HD

Part #	Description
28-001-58HD	Front Hanger
30-028HD	Rear Hanger
801-4	9/16" X 3-1/2" NF Suspension Bolt
810-2	7/16" NF Flanged Lock Nut
820-1	3/8" NF Nylock, Plated
820-5	5/8" NF Lock Nut Plated

Tandem Hanger Kit

Part # 571-33-HD

Part #	Description
28-001-58HD	Front Hanger
29-001HD	Center Hanger 3.5" High Heavy Duty
30-028HD	Rear Hanger
801-4	9/16" X 3-1/2" NF Suspension Bolt
810-2	7/16" NF Flanged Lock Nut
820-1	3/8" NF Nylock, Plated
820-5	5/8" NF Lock Nut Plated
541-3-58	Equalizer 5/8"

See W/T Assembly Sheet

Wheels

Part #	Rim Size	Bolt Circle	Capacity & psi	Type
15-1345-5-1	13X 4 1/2JJ	5 on 4.50	0 1360 @ 50psi	Eight Spoke
15-146-5-1	14X 5 1/2JJ	5 on 4.50	0 1870 @ 50psi	Eight Spoke
15-156-5-1	15X 6JJ	5 on 4.50	0 2050 @ 75psi	Eight Spoke
15-156-6-1	15X 6JJ	6 on 5.50	0 2600 @ 75psi	Eight Spoke
16-156-6-1	15X 6JJ	6 on 5.50	0 2600 @ 75psi	Mini-Mod

Wheels & Tire Assemblies

Part #	Rim Size	Bolt Circle	Capacity & psi	Load Range	Type
25-20575C14-5	14"	5 on 4.50	0 1760 @ 50psi	C	Eight Spoke
25-20575C15-5	15"	5 on 4.50	0 1820 @ 50psi	C	Eight Spoke
25-2057C15-6	15"	6 on 5.50	0 1820 @ 50psi	C	Eight Spoke
25-22575D15-5	15"	5 on 4.50	0 2050 @ 65psi	D	Eight Spoke
25-22575D15-6	15"	6 on 5.50	0 2540 @ 65psi	D	Eight Spoke
26-20575C15-5	15"	5 on 4.50	0 1820 @ 50psi	D	Modular
26-22575D15-6	15"	6 on 5.50	0 2540 @ 65psi	E	Modular
27-20575C14-5	14"	5 on 4.50	0 1760 @ 50psi	C	Aluminum
27-20575C15-5	15"	5 on 4.50	0 1820 @ 50psi	C	Aluminum
27-22575D15-6	15"	6 on 5.50	0 2540 @ 65psi	D	Aluminum





CONTACT NUMBERS



HEAD OFFICE & MAIN PLANT

1222 - 58th Avenue S.E.
P.O. Box 67, Station "T"
Calgary, Alberta
Canada T2H 2G7

Toll Free: 1-800-663-7800
Phone: (403) 258-7800
Fax: (403) 258-7897
Toll Free Fax: 1-866-258-7897

www.standens-axles.com

DISTRIBUTION CENTRES

EDMONTON

18922 - 111 Avenue NW
Edmonton, AB
Canada T5S 0B6
Phone: (780) 430-7130
Fax: (780) 430-7037

VANCOUVER

1880 96 Avenue
Surrey, BC
Canada V4N 3R1
Toll Free: 1-800-665-9633
Phone: (604) 888-7287
Fax: (604) 888-7260

BOUCHERVILLE

220 Industriel Boulevard
Boucherville, QC
Canada J4G 2X4
Toll Free: 1-866-674-0855
Phone: (450) 674-0855
Fax: (866) 674-0938

DISTRIBUTION CENTRES

TORONTO

1400 Meyerside Drive
Mississauga, ON
Canada L5T 1H2
Toll Free: 1-800-567-7800
Phone: (905) 362-1901
Fax: (905) 362-1906

INDIANA

6450 English Avenue
Indianapolis, IN
U.S.A. 46219
Toll Free: 1-800-851-2254
Phone: (317) 423-1471
Fax: (317) 423-1925

SERVICE CENTRE

1222 - 58th Avenue S.E.
P.O. Box 67, Station "T"
Calgary, Alberta
Canada T2H 2G7
Toll Free: 1-800-663-7800
Phone: (403) 258-7800
Fax: (403) 258-7897
Toll Free Fax: 1-866-258-7897